



BG-24

True Diversity
Wireless Microphone

Quick guide

BG-24 Receiver

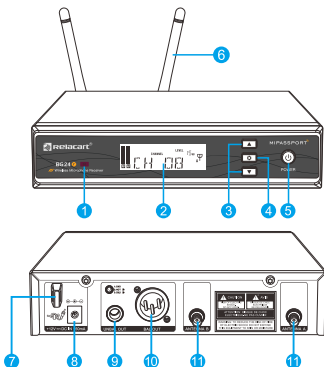

- | | |
|--|--------------------------------------|
| 1 Infrared Data Transmission Window (iR) | 7 Anti pull device |
| 2 LCD display screen | 8 DC power socket |
| 3 Select button | 9 Φ 6.3mm parallel audio output |
| 4 Set button | 10 XLR balanced audio output |
| 5 Power switch | 11 RF antenna input |
| 6 SMA antenna | |

BG-24 Wireless handheld microphone

- 1 Microphone pickup module
- 2 Display
- 3 Power switch
- 4 Microphone handle
- 5 IR synchronization window
- 6 Battery compartment
- 7 Charging contact

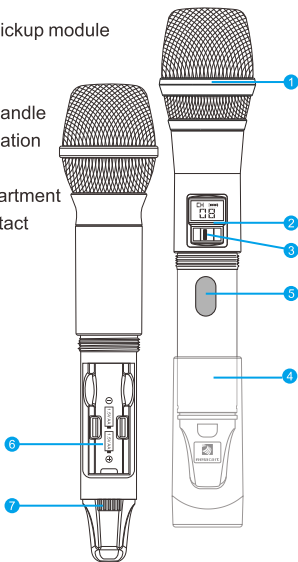

BG-24 Wireless bodypack transmitter

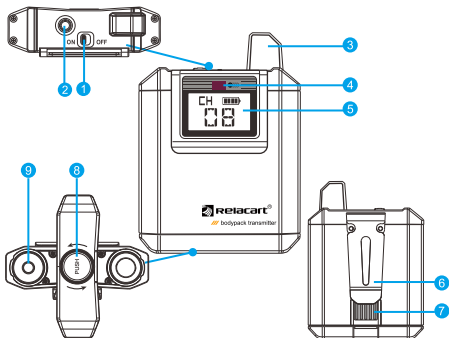

- | | |
|-----------------------------|-----------------------------------|
| 1 Power switch | 6 Fixed back clip |
| 2 Audio input socket | 7 Charging contact |
| 3 Transmitting antenna | 8 Battery compartment open button |
| 4 IR synchronization window | 9 Battery compartment window |
| 5 Display | |

Charging stand(Optional)

- 1 Power indicator light
- 2 Charging status indicator light
- 3 Charging cabin
- 4 Charging dock level connection port
- 5 Charging dock connection accessory slot
- 6 Charging dock connector
- 7 DC IN power socket
- 8 Reset hole

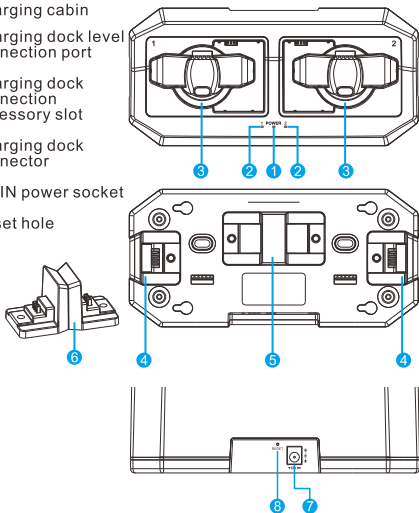

Charging stand usage

When charging, put the transmitter with the NiMH rechargeable battery installed into the charging compartment, as shown in the figure. (It cannot be charged if non-rechargeable batteries are installed)

LED lights up to indicate battery status

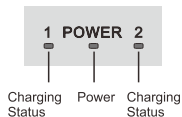

	Status	Indicator
1/2 Charging Dock	Charging	Red Slow Flashing
	Charging Completed	Green
	Error/Abnormal	Red Fast Flashing
Power	Power supply is normally connected	Red

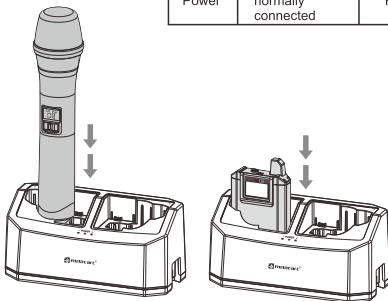

SMA antenna installation

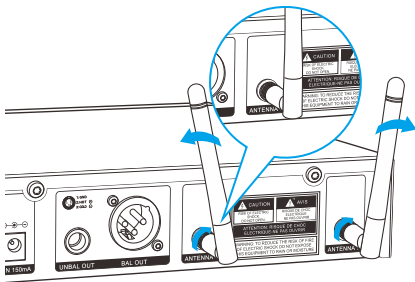
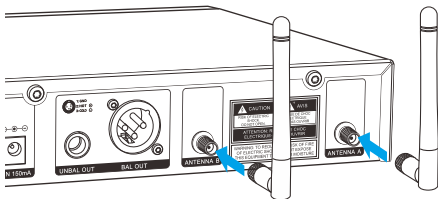

Connect the power adapter

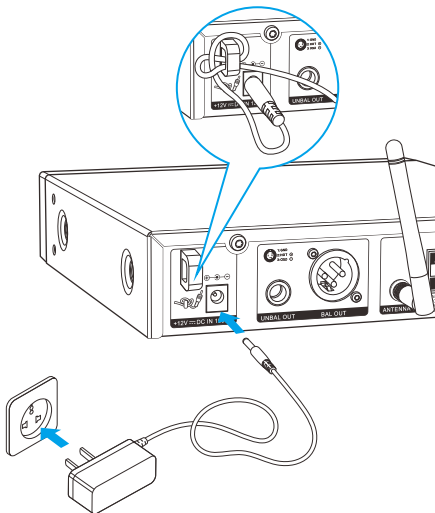

Use a power adapter that meets local regulatory requirements

Connect audio output

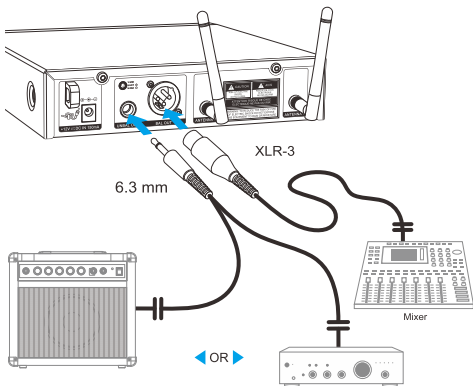

ON/OFF

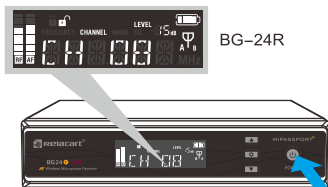

BG-24R

Short press "ON"
Long press "OFF"

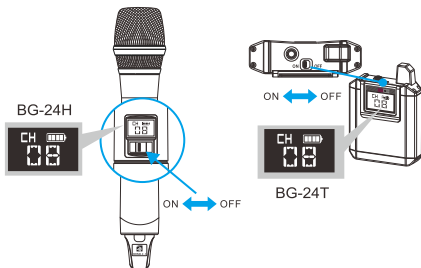

BG-24H

BG-24T

Display



Receiver

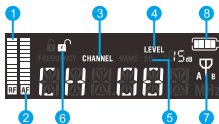

Transmitter



- 1 RF signal
- 2 Audio output signal
- 3 Channel
- 4 Volume level
- 5 Volume level value

- 6 Receiver keyboard lock
- 7 RF antenna status
- 8 Transmitter battery level

Operations



Long press



Short press



Short press



Short press



Short press



Short press



Short press



Short press



Short press



Short press



Short press



Short press



Short press



Short press



Short press



Short press



Short press



Short press



Short press



Short press



Automatic frequency search



Long press "▲" 3 seconds



After entering the "AFS" function for automatic frequency scanning, a channel search interface will appear.



Find the current interference -free frequency

Synchronous frequency matching

1



Long press "⚙️" 3 seconds



Short press "▼" to select the "SYNC" menu



Short press "⚙️" to confirm and start frequency matching

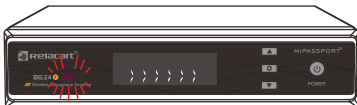

During the frequency matching process, the receiver's iR frequency matching light flashes

2

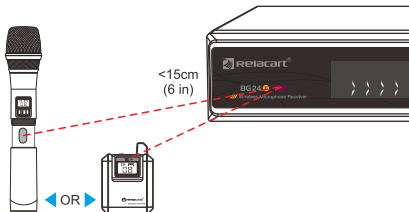

Align the infrared frequency matching iR windows of the transmitter and receiver

3

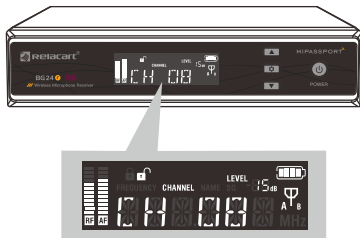

Both the receiver and transmitter display the same frequency after completing the frequency matching



BG-24T

◀ OR ▶

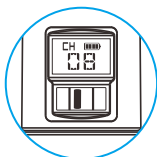

BG-24H

After successful channel synchronization between the transmitter and receiver, the channels of the transmitter and receiver are consistent; When using a transmitter to speak, the "AF" signal on the display screen indicates that there is audio output when it jumps.

4



BG-24T



◀ OR ▶



BG-24H

Attention: When using iR infrared frequency matching, the cover of the handheld microphone must be opened; Otherwise, it will affect the frequency function.

Audio output adjustment



Long press "⚙️" 3 seconds



Short press "▼" to select the "LEVEL" menu



Press "⚙️" to enter the audio level setting and adjust it sequentially (there are 9 levels to choose from), press "⚙️" to complete.

Receiver key lock



Long press "⚙️" 3 seconds



Short press "▼" to select the "LOCK" menu



Press "⚙️" to select keyboard lock "ON" or unlock "OFF", select "ON" and press "⚙️" to lock the receiver and prevent any operation.

Encryption enabled



Long press "⚙️" 3 seconds



Short press "▼" to select the "CRYPT" menu



Press "⚙️" to select keyboard lock "ON" or unlock "OFF", select "ON" and press "⚙️" confirm

When turn on AES-256 bit encryption, which provides unbreakable privacy protection and eliminates stray RF interference by allowing only encrypted signals to be transmitted to the receiver. The system delay is 3.8ms after the encryption function is turned on.

*After setting this function, you need to re-synchronize the frequency.

Installation of transmitter battery

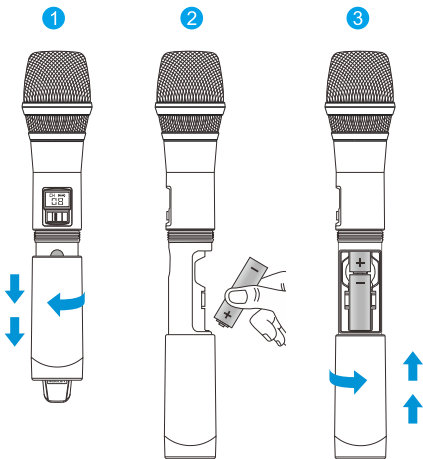

2 AA batteries
(pay attention to polarity markings)

- 1 Press 'PUSH' and rotate the battery door counterclockwise at the same time

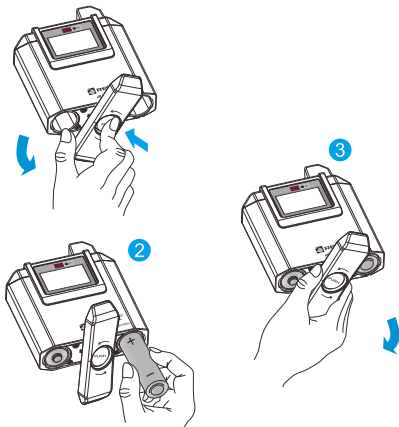

2 AA batteries
(pay attention to polarity markings)

Usage of transmitter

BG-24T

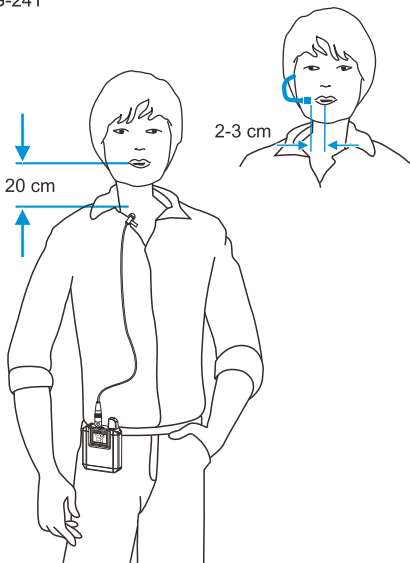

BG-24H

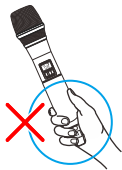
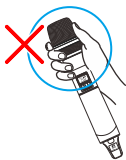
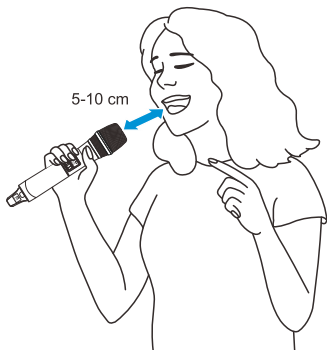

specifications

Model: BG-24 Receiver

Receiving Channel:	Single channel
Reception Method:	Antenna diversity/frequency diversity/Time Diversity
Audio Format:	Relacart proprietary digital audio format
Wireless Carrier Frequency:	2.4-2.48GHz
Compatible Channels:	≥ 14
Display Channel:	LCD
Effective Distance:	70 meters (open space)
Sampling:	24bit/48kHz
Encryption:	AES-256
Delay:	≤2.9ms, ≤ 3.8ms (encryption enabled)
Dynamic Range:	≥ 110dB (A-weighted)
Frequency Response:	20Hz-20kHz(± 1dB)
Comprehensive T.H.D:	<0.1% @ 1KHz
System Gain Adjustment:	(-18~18 dB)
Audio Output Interface:	XLR balanced output, 1/4 "unbalanced output
Power Supply:	DC/12V
Current Load:	≤150mA
Dimensions(mm):	200 (L) x 200 (D) x 44 (H)

Model: BG-24 Transmitter

Audio Format:	Relacart proprietary digital audio format
Wireless Carrier Frequency:	2.4-2.48GHz
Transmission Method:	Frequency diversity
Modulation Method:	GFSK
Transmission Rate:	1Mbps
Sampling:	24bit/48kHz
Compatible Channels:	≥ 14
Display Channel:	OLED
Dynamic Range:	≥ 110dB (A-weighted)
Frequency Response:	20Hz-20kHz (± 1dB)
Sensitivity:	≤ -45dB
RF Power:	≥ 50mW
Power Supply:	Alkaline battery (AA) x 2
Current Load:	145mA (typical value)
Battery Life:	≥ 8 hours
Handheld microphone	
Dimensions(mm):	55 (Φ) × 269 (L)
Bodypack transmitter	
Dimensions(mm):	65 (L) x 21.3 (W) x 75.5 (H)



www.relacart.com

Online Manual

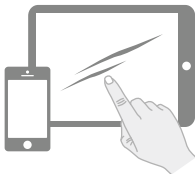

www.relacart.com/downloads

Q BG-24_



 @relacart

 @relacart

 @relacart

Relacart Electronics Co., LTD.

1302, South tower world trade centre complex,
371-375 Huanshi Dong Road, Guangzhou